

Design | Mold | Plastic Injection | Serigraphy | Assembly | CMM Reverse Engineering



## **We Produce By Considering The Whole...**

We know the expectations of the global brands and the dynamics of the production of these brands

[www.talesplastik.com.tr](http://www.talesplastik.com.tr)





# Tales

## Tales Plastic

Tales Plastic was founded in 2005.

It provides Design, Mold and Plastic Production services in an area of 11000 m<sup>2</sup>



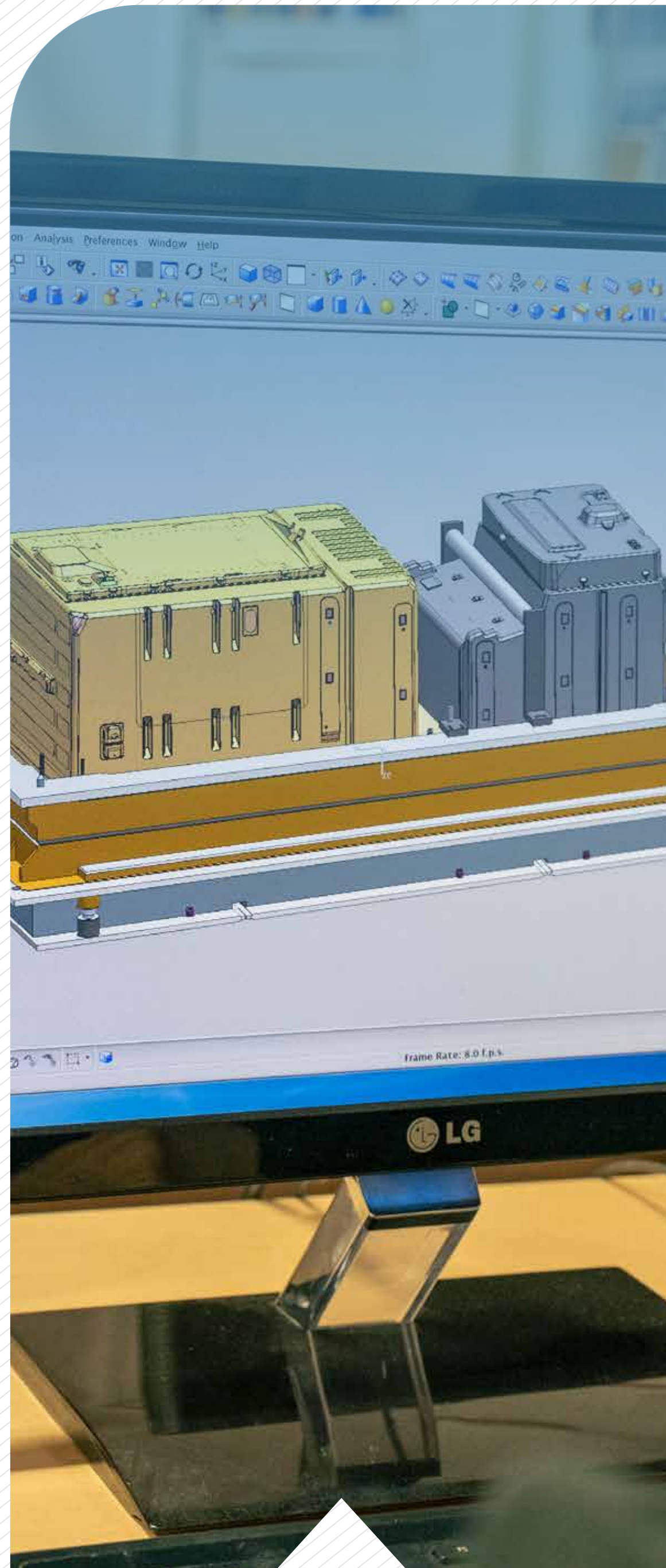

Design



Mold



Plastic  
Injection

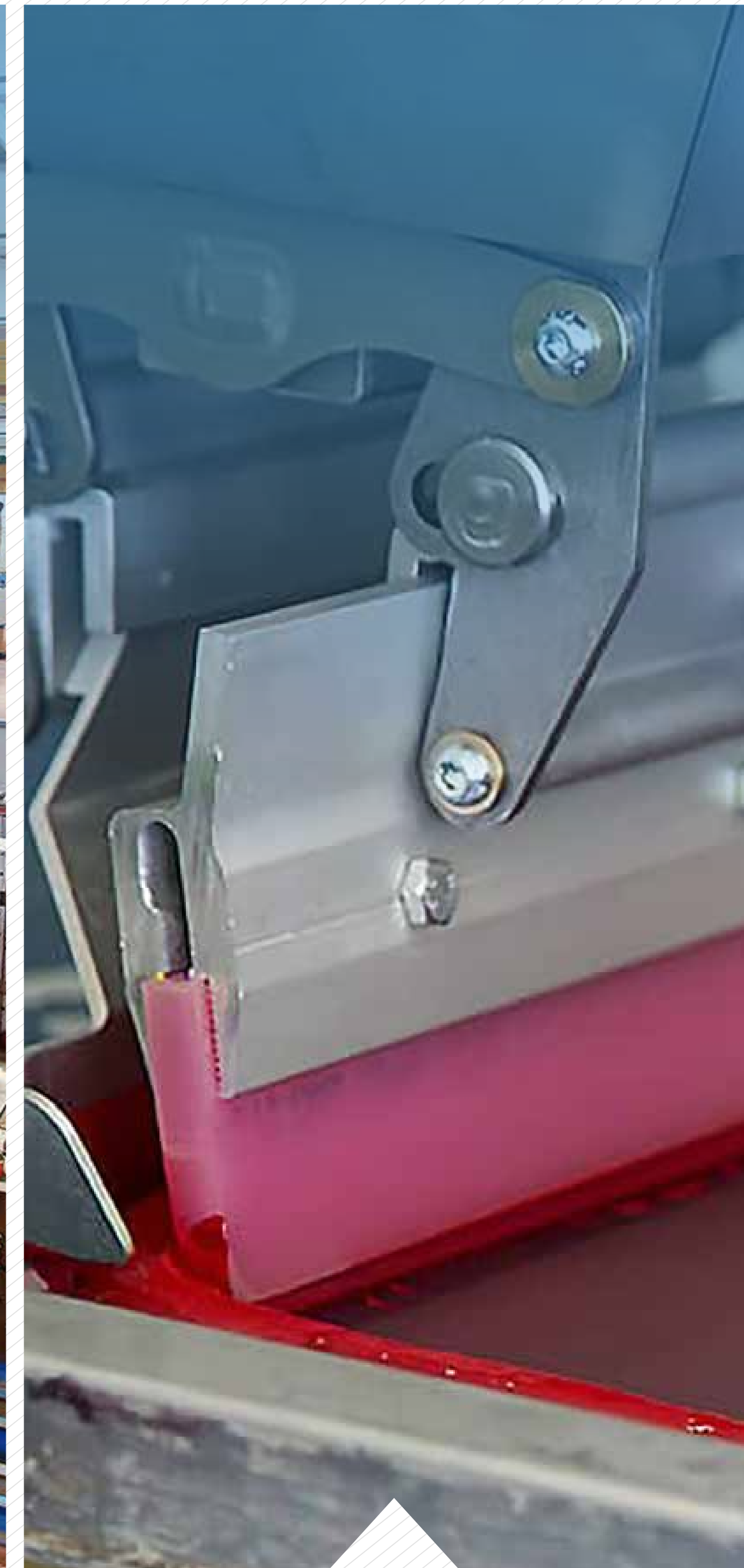

Serigraphy

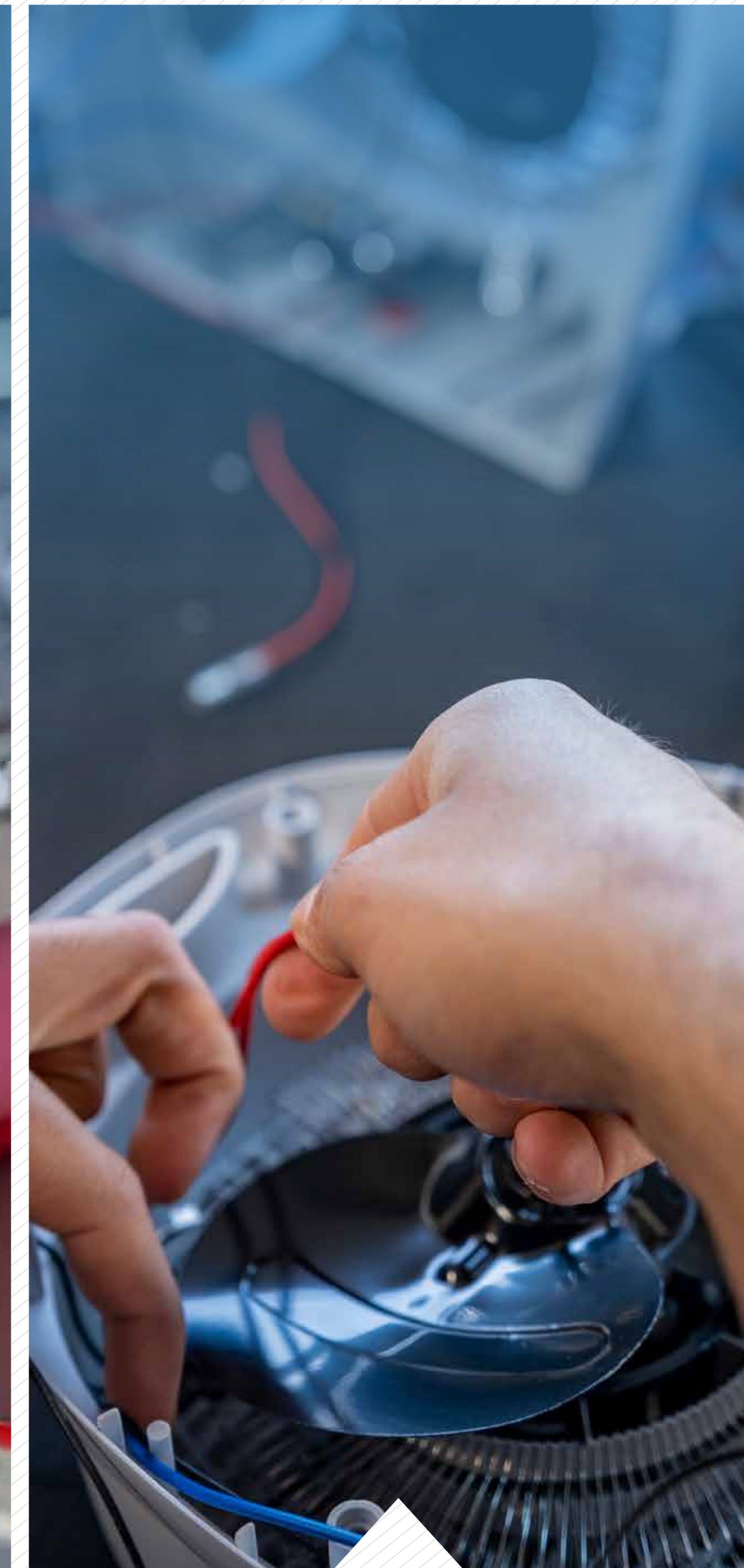

Assembly

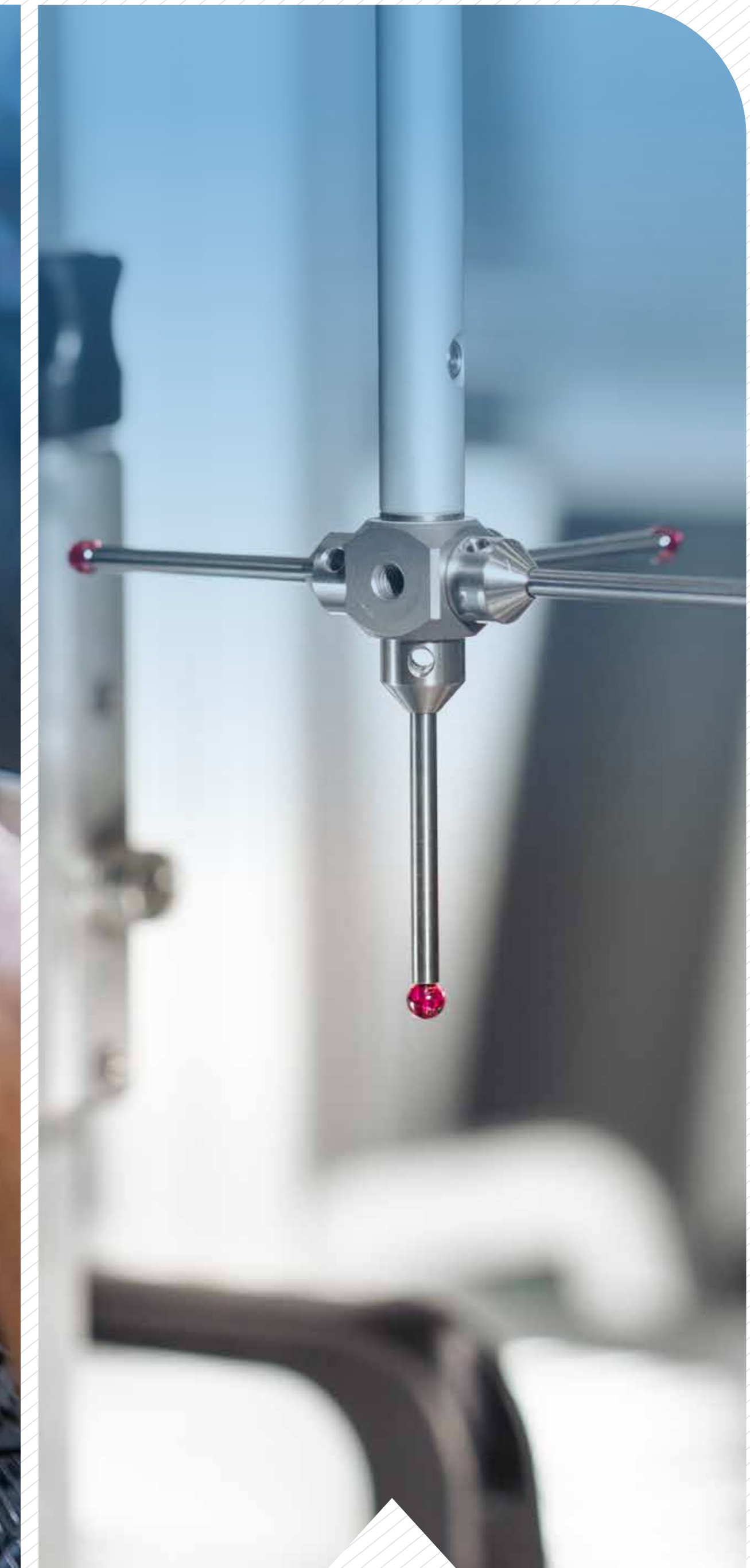

CMM  
Reverse  
Engineering



# Sectors

White Goods | Electric & Electronic | Automotive







# We Produce By Considering The Whole...

We know the expectations of the global brands and the dynamics of the production of these brands. We approach all projects by considering the whole.





## ANALYSIS

Quality Product  
High Performance  
Best Fit

Our engineer team realizes the project analyses according to the quality product, high performance and best fit. Production processes are planned by evaluating the results of the analysis together with the brand and making necessary corrections.





# Experience

With 25 years of experience, we make produce always with the same quality and precision, regardless of unit production or million production.



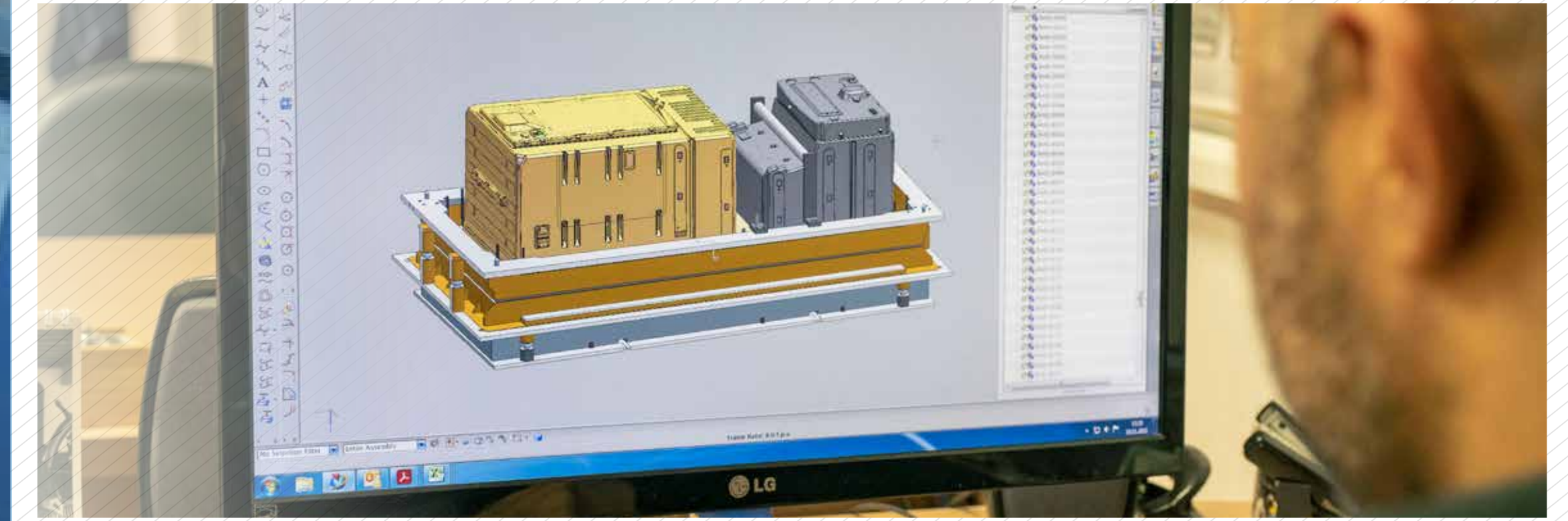
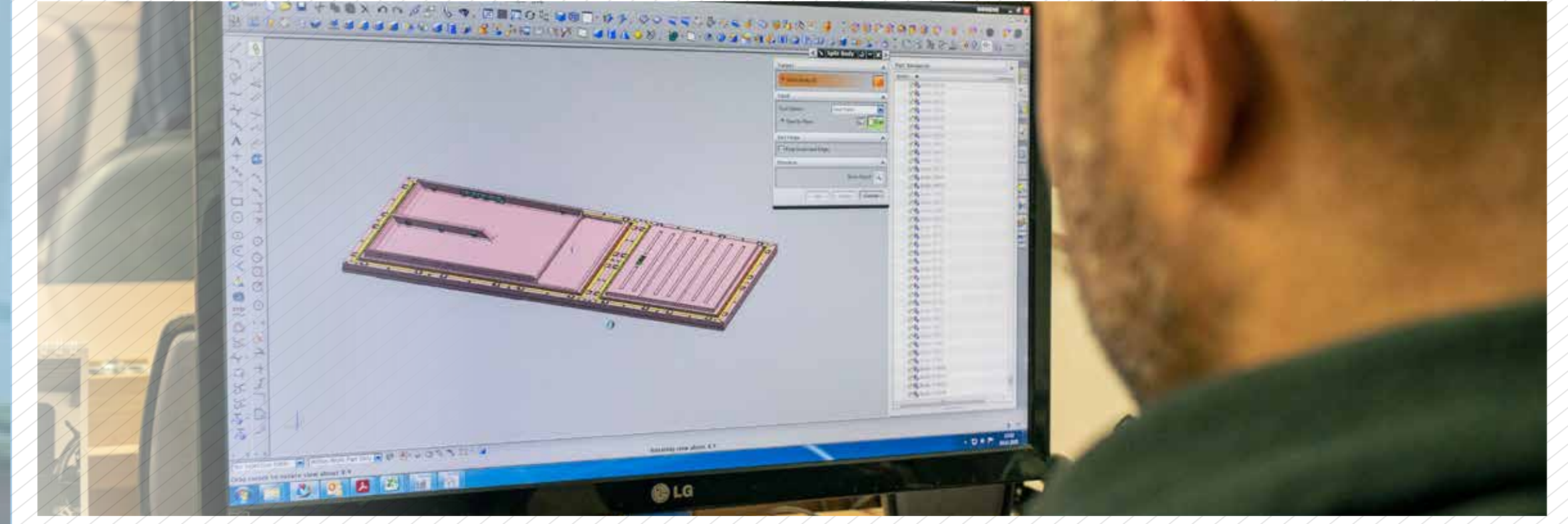
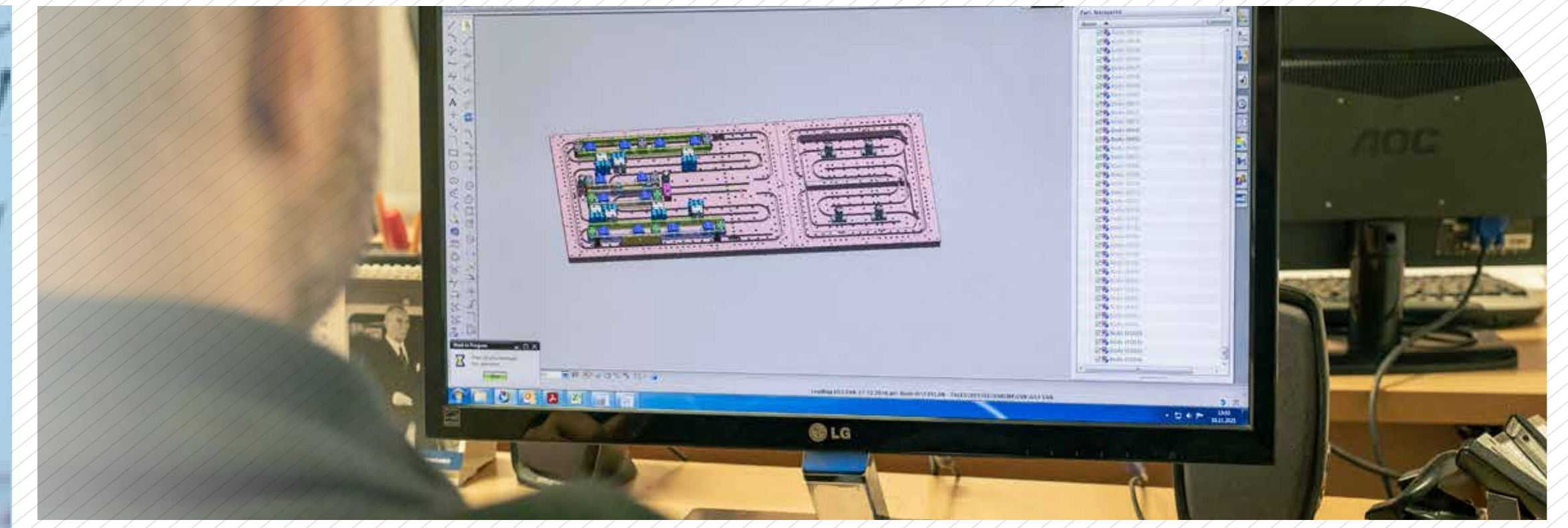

# Design

The current project design is prepared in the most appropriate way to production. Reverse engineering activities are realized over the final product as well.



# Engineering

It gives you the support you need in industrial design, analysis and calculations, prototyping, testing and controls, costing and transition to production. It is ensured to establish a cost balance by considering all the factors required for production such as the amount of the product to be produced, the place of use, at which machine the production will be made etc. and by making a design of the mold.

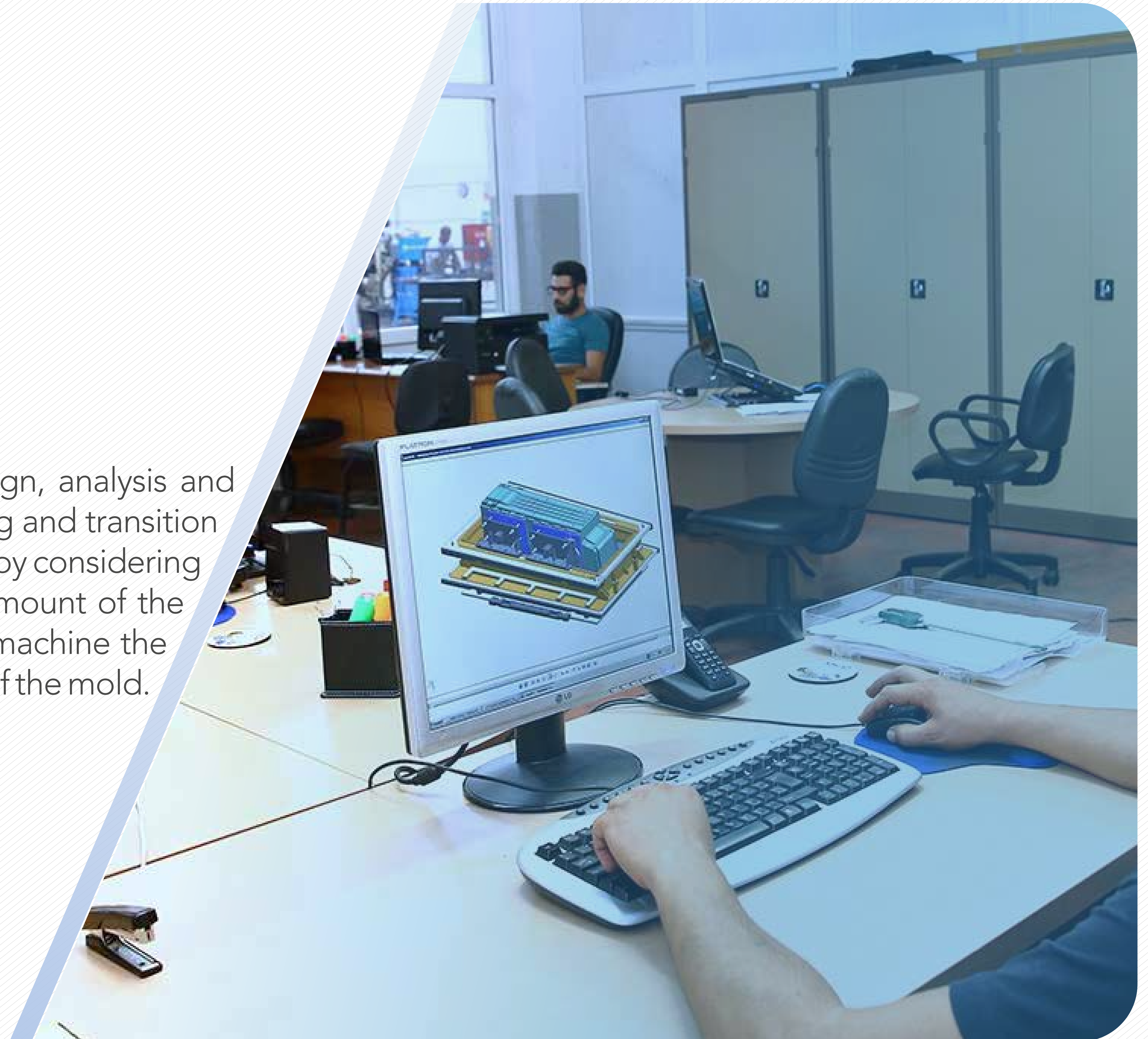





# Mold

We work on the projects in line with your demands, complete the analyses and designs in the most correct way, move on to the production stage and produce "Cabinet Thermoform Mold, Cabinet Polyurethane Mold, Door Thermoform Mold, Door Polyurethane Mold, Core Frame (polyurethane quick connect), Styrofoam Mold, Trim Mold".



# Products

## Mold Production

Cabinet Thermoform Mold

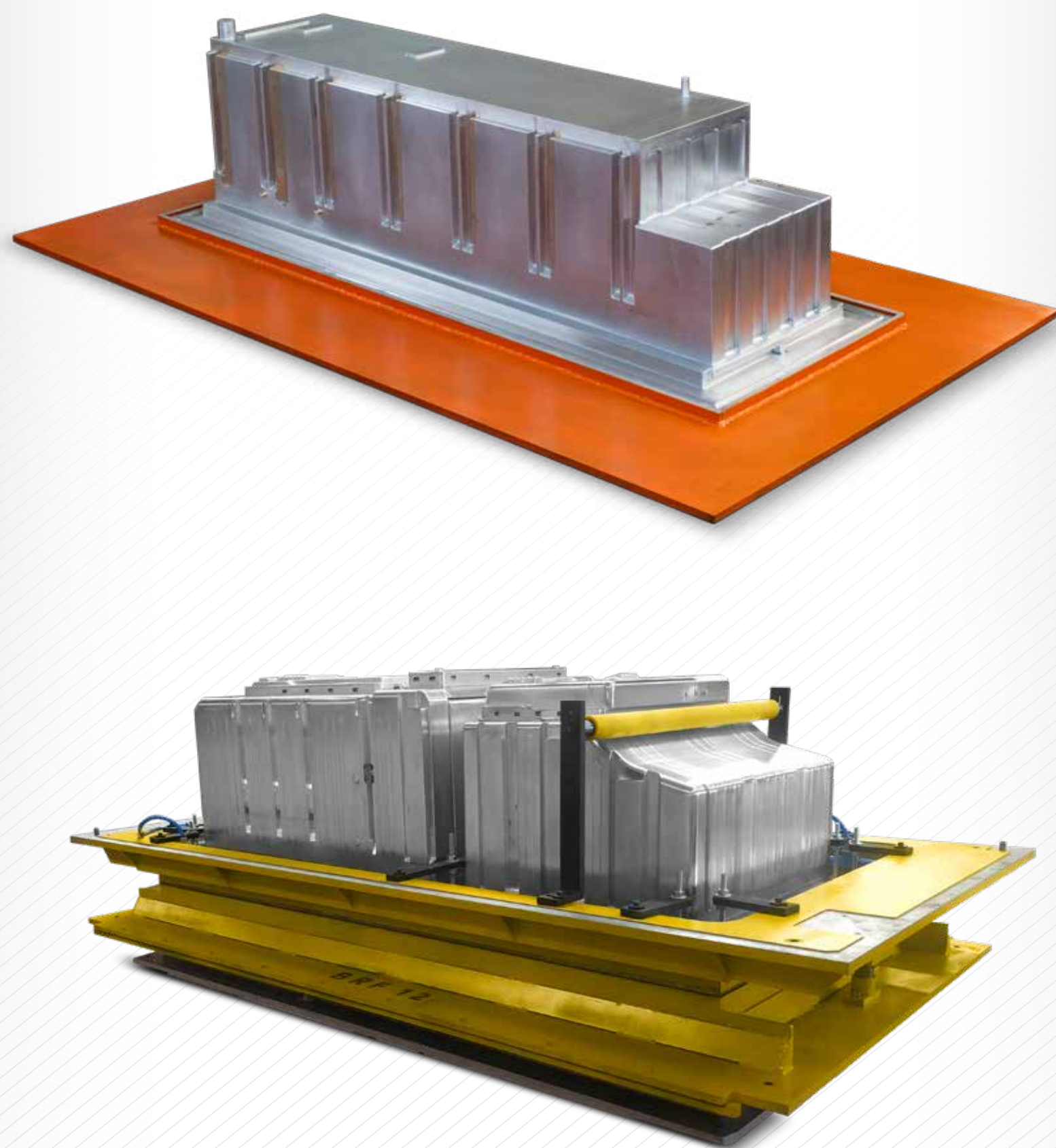

Cabinet Polyurethane Mold

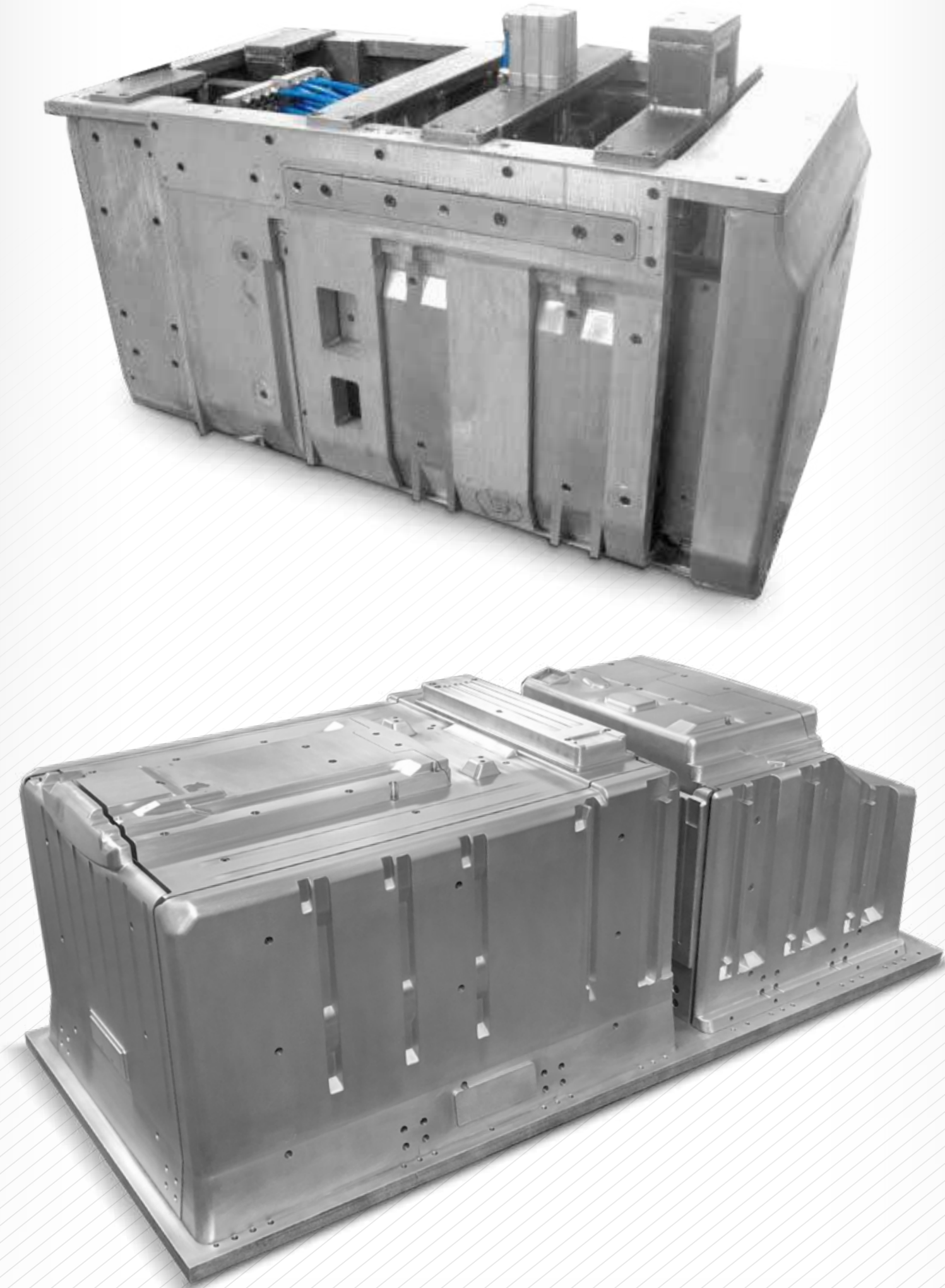

Door Thermoform Mold



Door Polyurethane Mold





# Products

## Mold Production

Core Frame

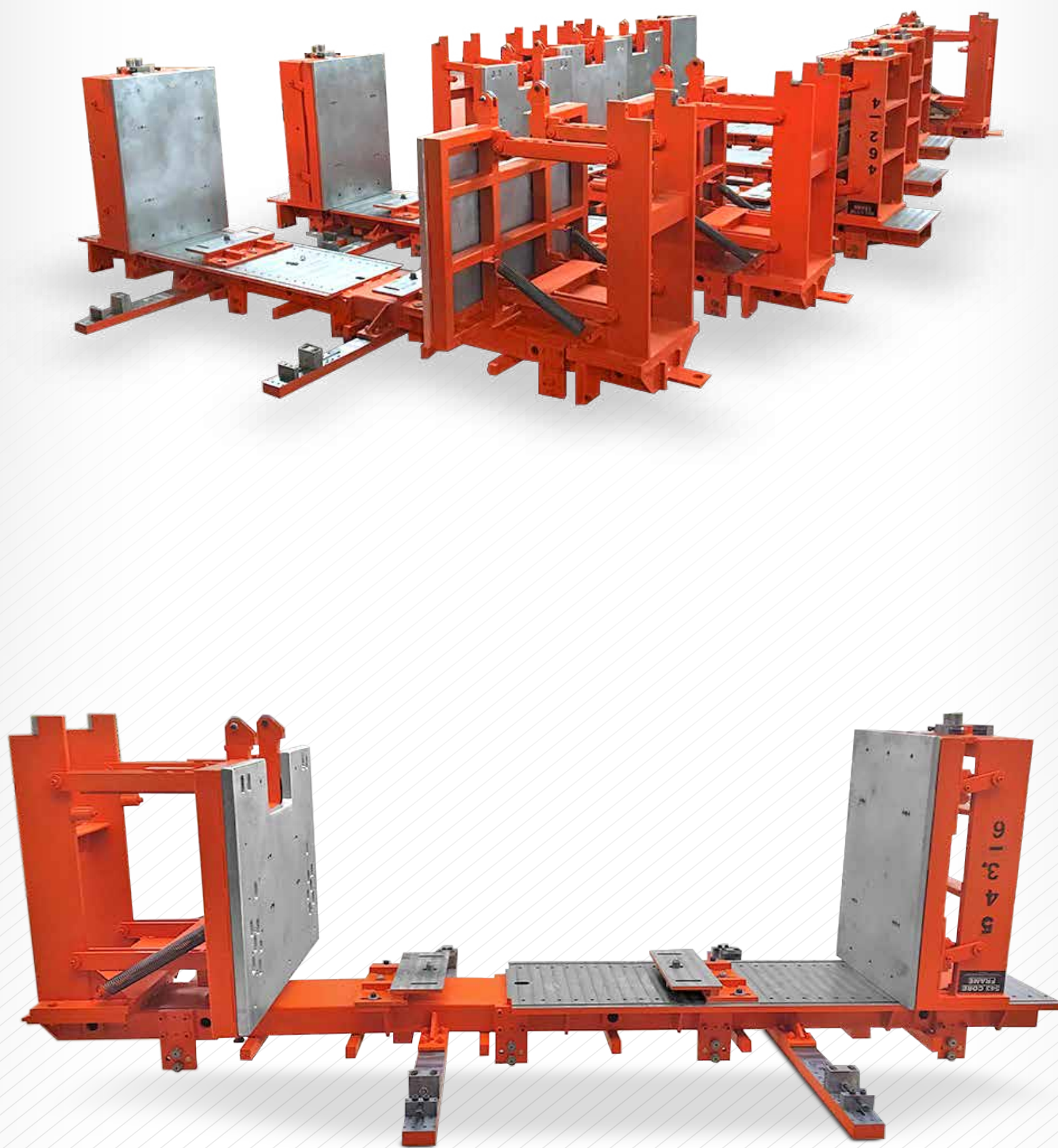

Styrofoam Mold

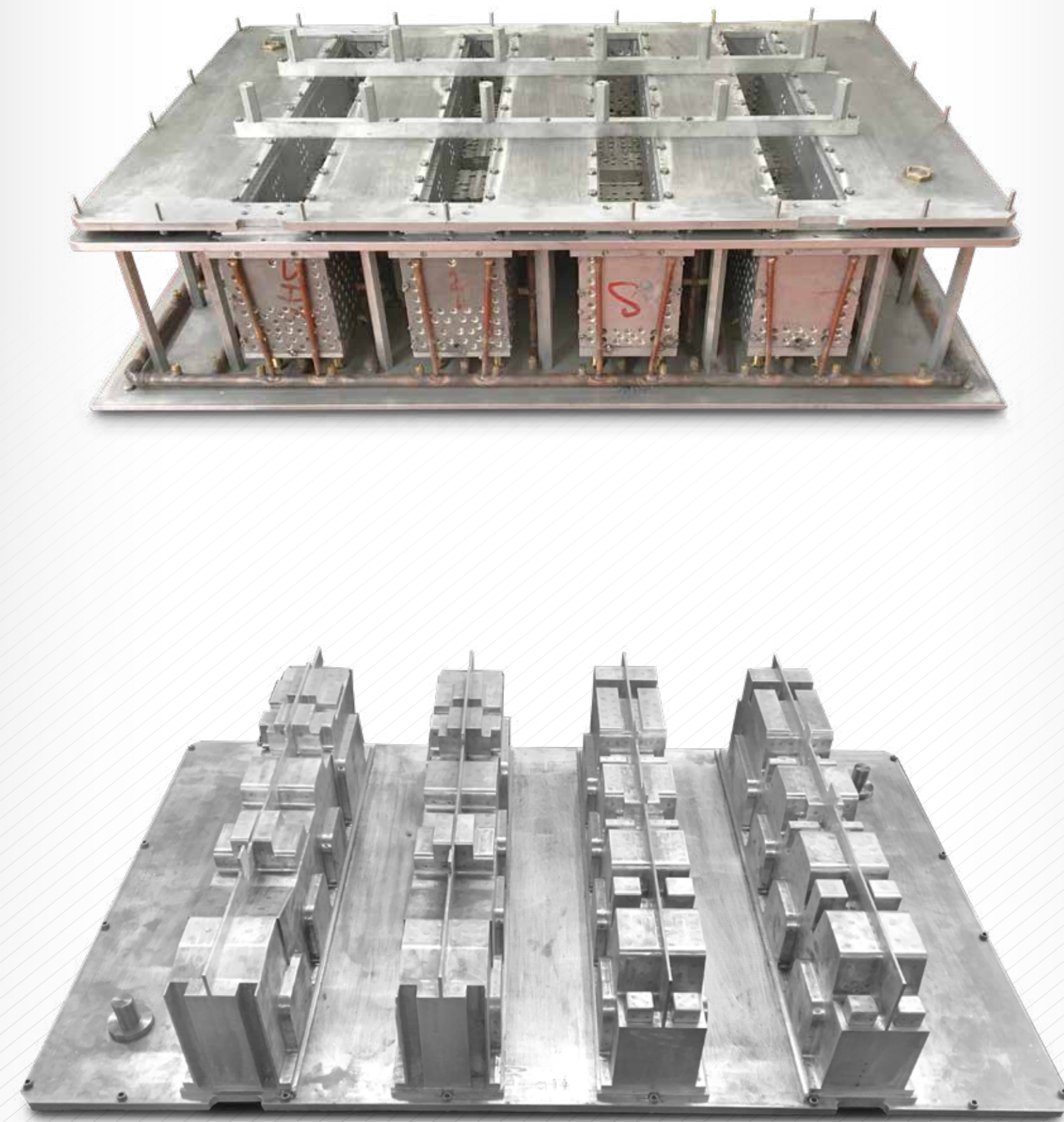

Trim Mold

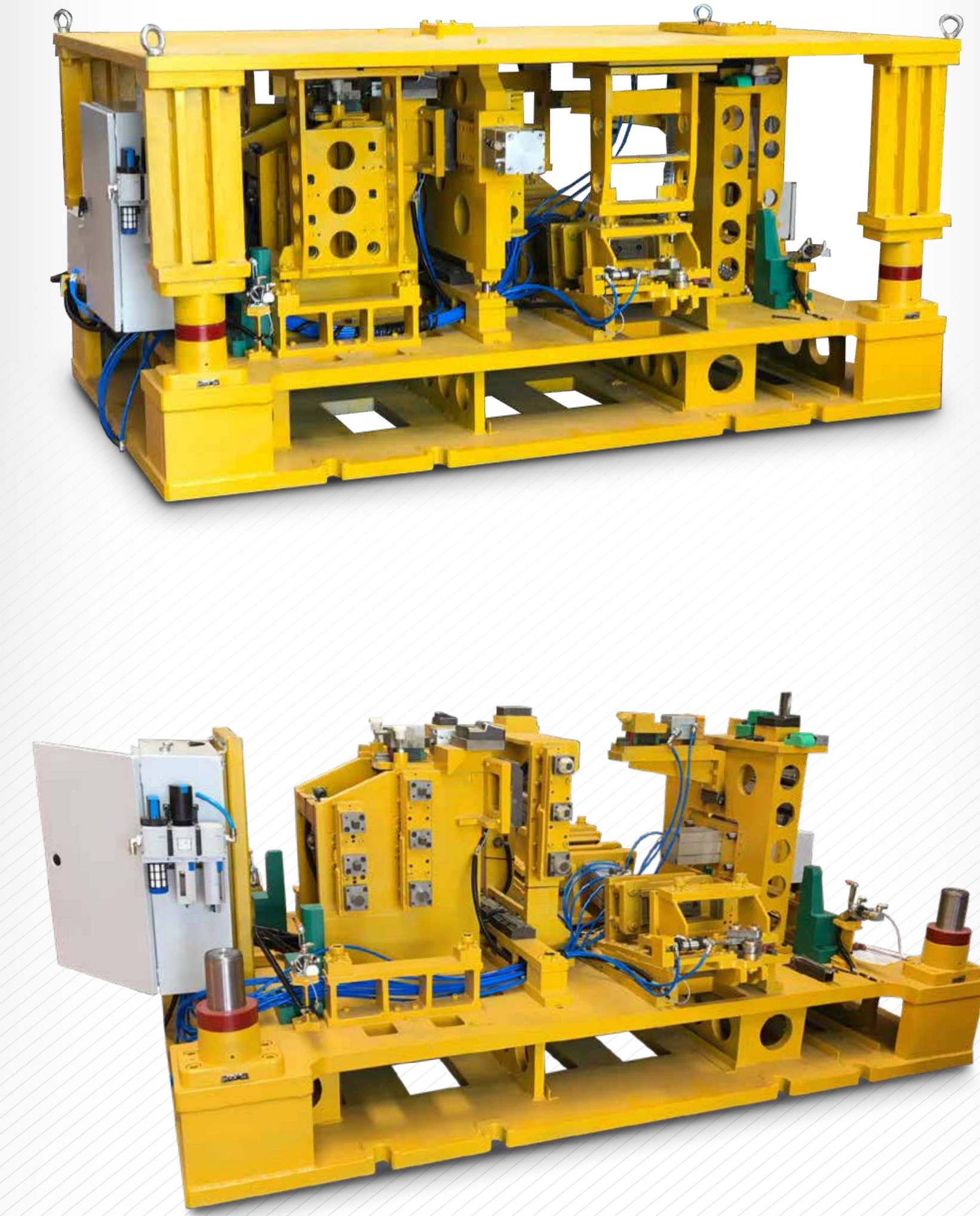





# Plastic Injection

- Expert staff with minimum 12 years of experience
- 24 Plastic injection machines (160-700 tons)
- We can make production of all products between 50 gr and 3 kg.
- Production capacity of 2500 tons per year







# Raw Material

PP | ABS | Glass | Fibre additive raw material | Pc | PA | Crystal raw material



# Robotic System

Our using the robotic system during the production phase prevents the issues such as product loss, damage etc. in all works compared to the manual production.





# Advanced Design High Precision

High Precision - Good Strength

In engineering products that require high precision, the deflection is 0,002%



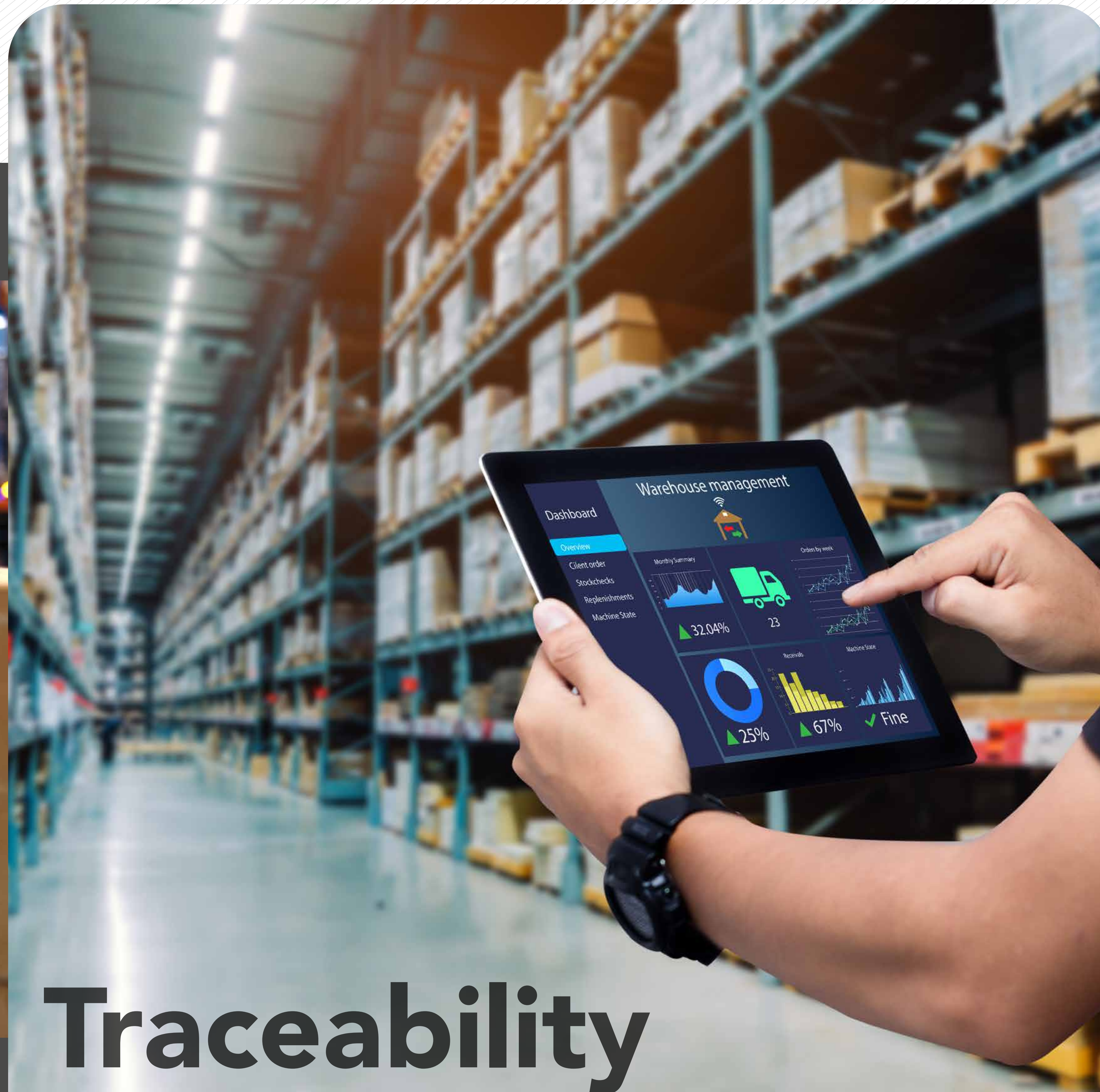

# Traceability

Being aware of the importance of traceability, not limited to production, Tales makes complete tracking of barcode system, stock and production.



# Serigraphy

With our full automatic and semi-automatic and manual serigraphy machines, we can print on any kind of surfaces from 0,1 mm to 10 cm. With UV Printing and Solvent dyes, we provide quality printing services by using the latest technology in single-colour, multi-colour, monotone, and tram prints.





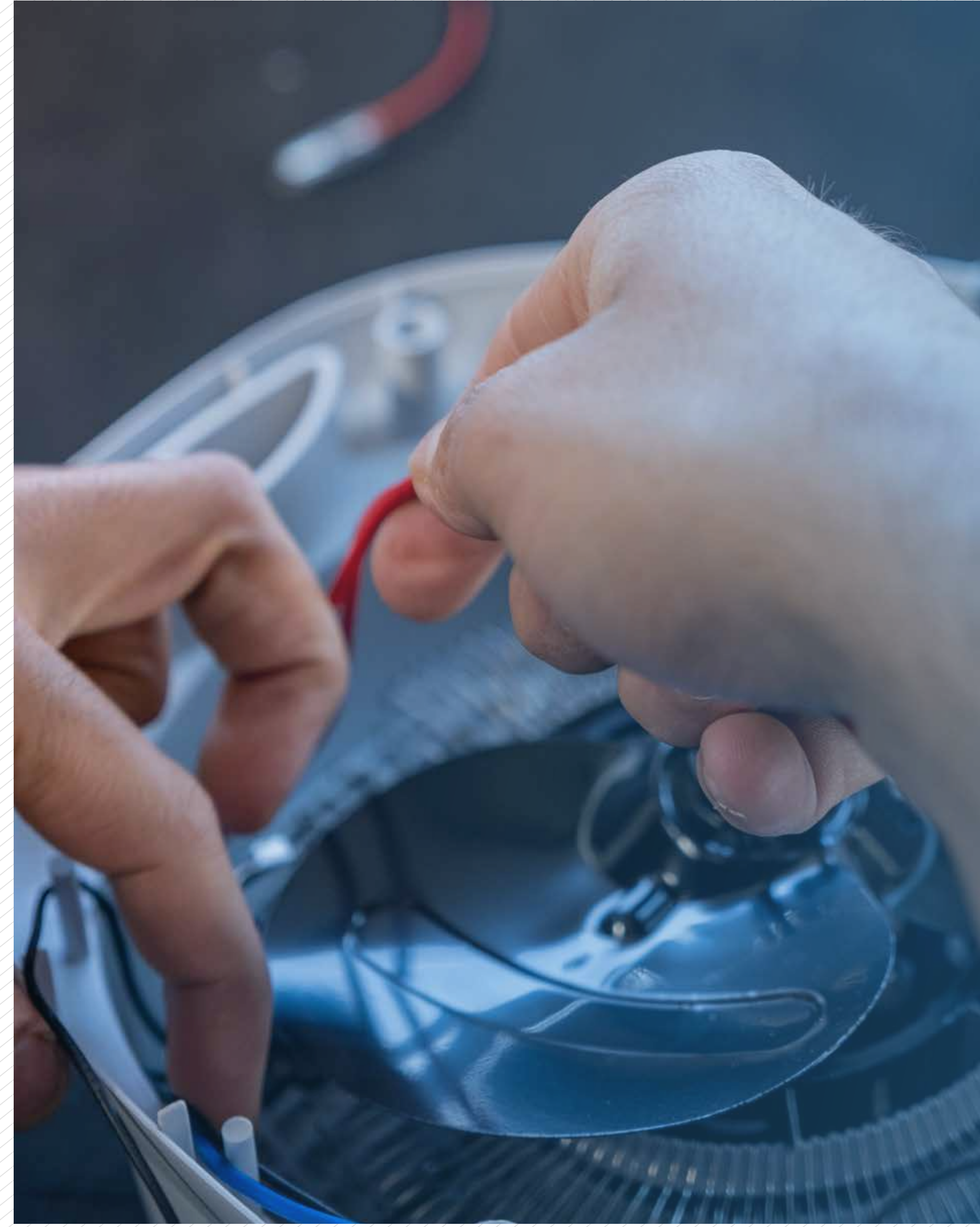
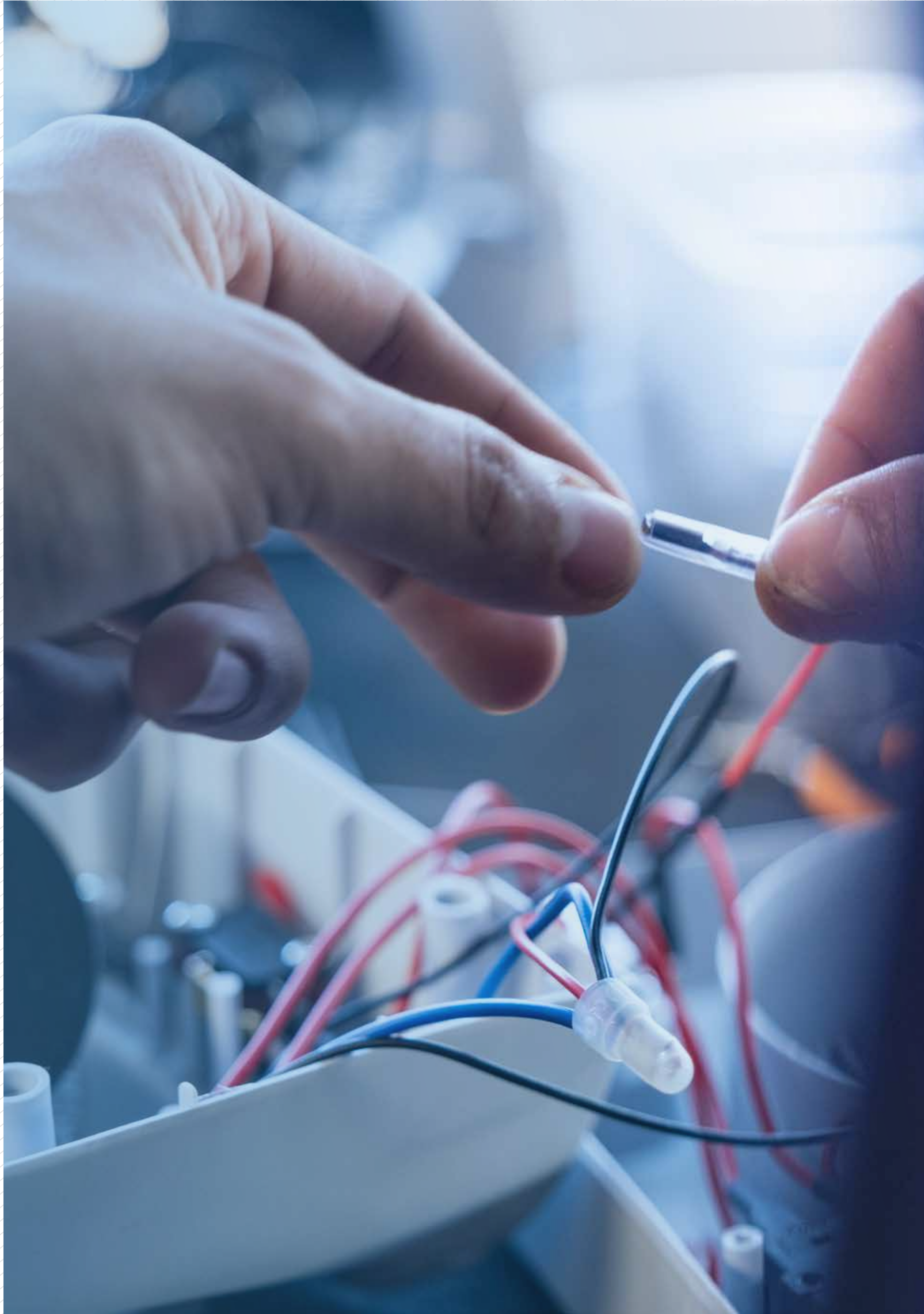

# Assembly

After printing process, we also realize the assembly process. Thanks to this, we offer ready-packaged and quality-controlled products.





# Products

## Plastic Injection

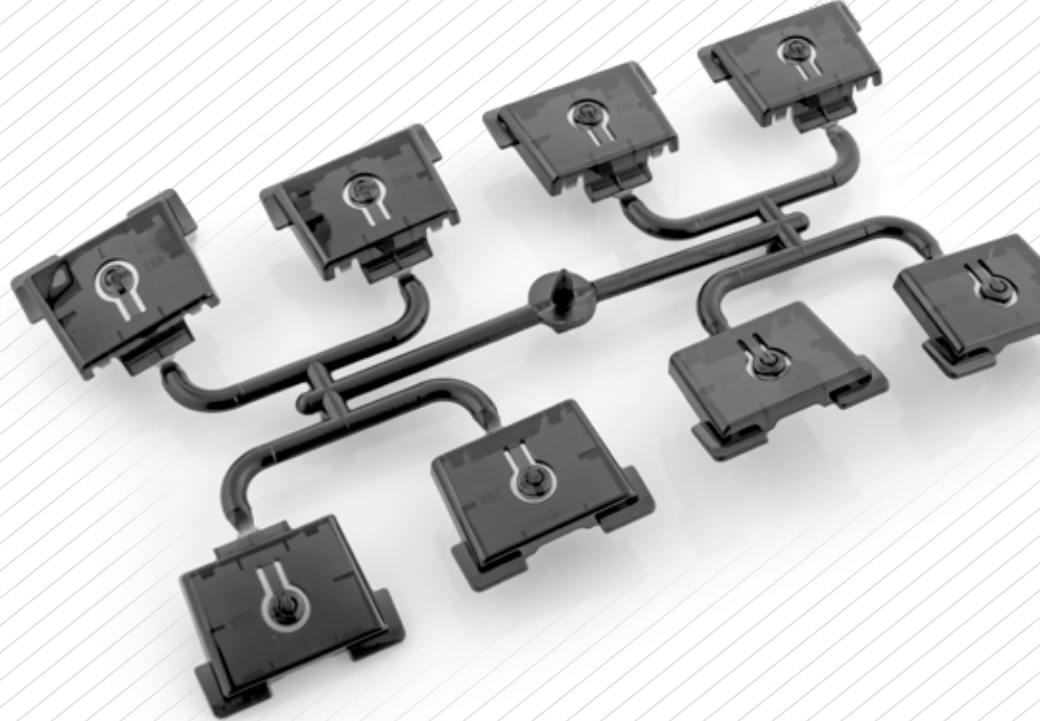
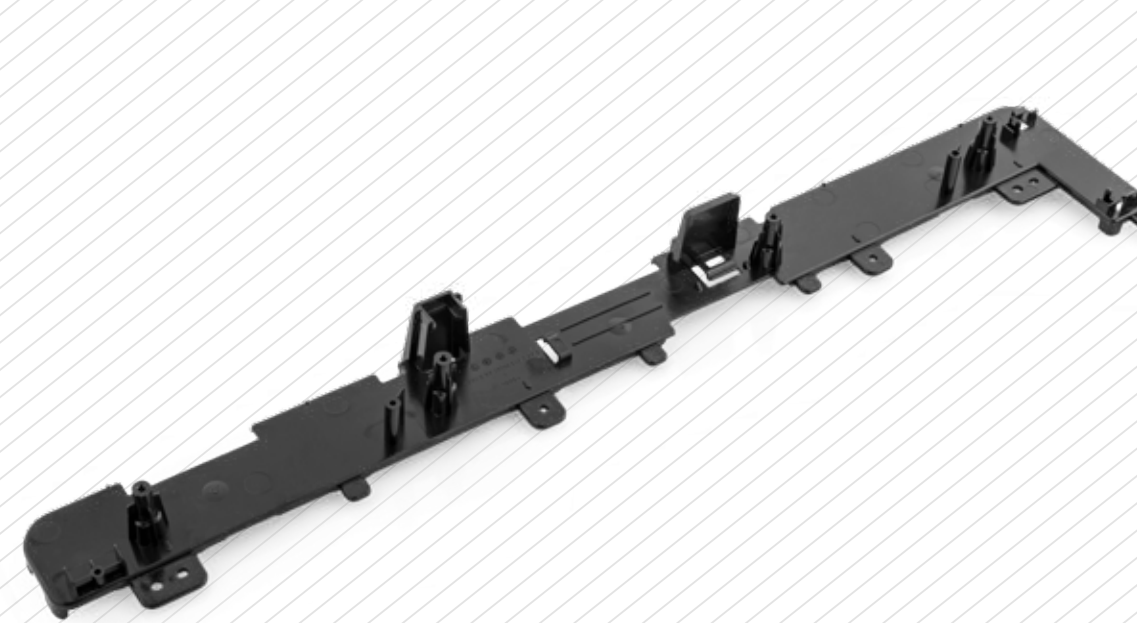



# Spacious and Sheltered Warehouse Space

While mass production of high-volume orders is made, the finished products are kept in a large and sheltered warehouse area. After the order quantity is completed, the logistics are provided at once.

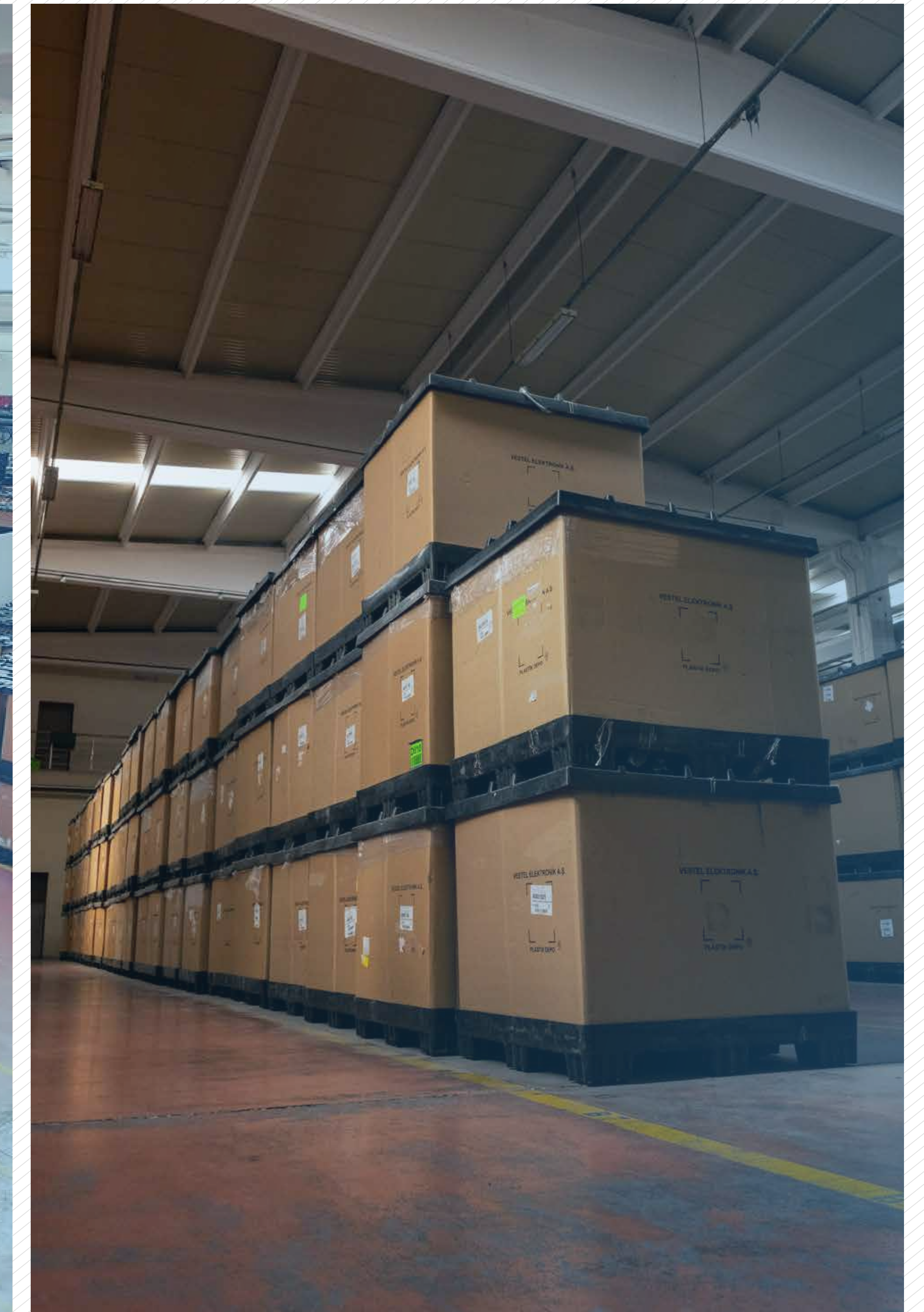



# References







Adress : Muradiye Mah. 35 Sok. No:7  
Yunusemre / MANİSA – Türkiye 45140

Tel : +90 236 214 01 40 / 41  
Faks : +90 236 214 01 42  
E-mail: info@talesplastik.comtr

[www.talesplastik.com.tr](http://www.talesplastik.com.tr)